

# 1-2-1-4. Ceiling Type S-3650PT3E

unit :mm

**Detailed view of intaking outside air duct connection port**

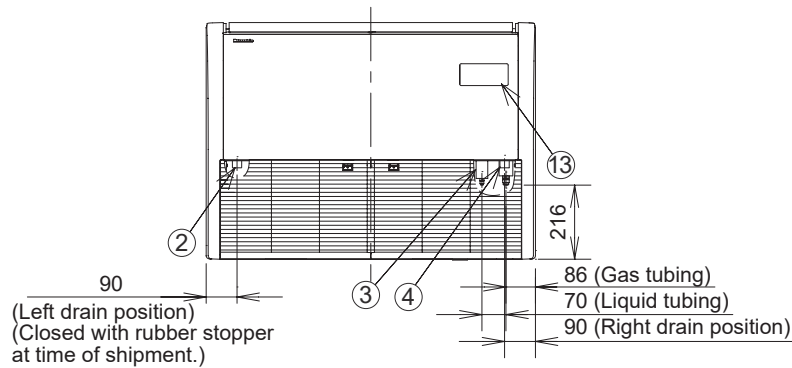
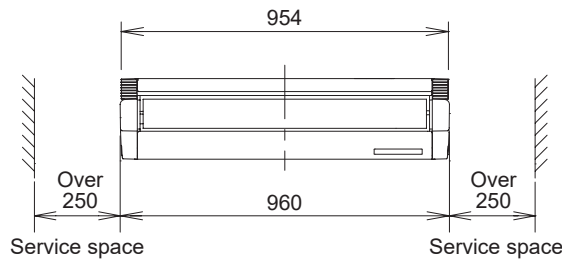
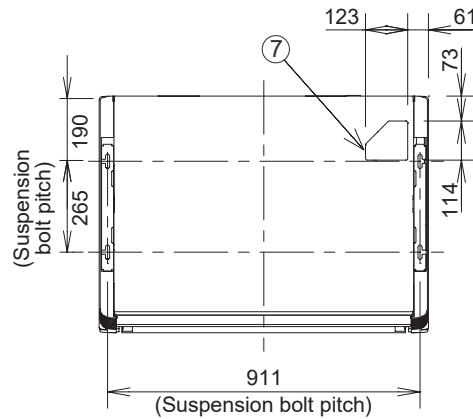
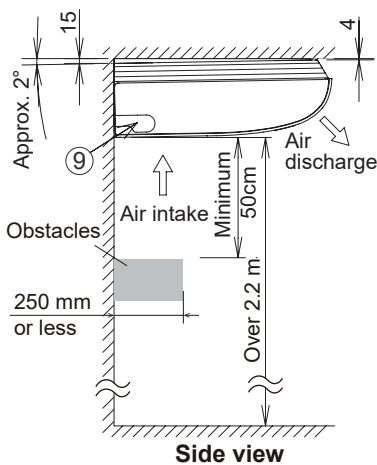
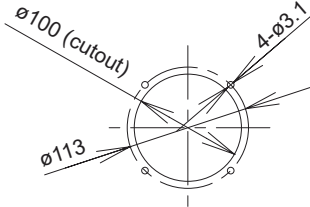

**Distance of each exposed bolt must be of equal length within 50mm.**

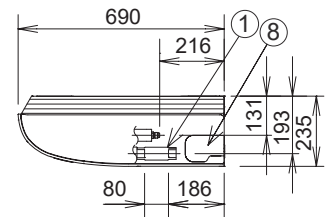
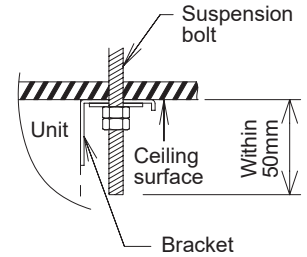

①	Drain port VP20 (inside diameter $\phi 26$ mm, drain hose supplied)
②	Left drain position
③	Refrigerant liquid tubing ( $\phi 6.35$ mm, flare connection)
④	Refrigerant gas tubing ( $\phi 12.7$ mm, flare connection)
⑤	Cover of rear tubing hole
⑥	Tubing hole on wall surface ( $\phi 100$ mm)
⑦	Upper side tubing port
⑧	Right side drain hose outlet port (cutout)
⑨	Left side drain hose outlet port (cutout)
⑩	Left-rear side drain hose outlet port (cutout)
⑪	Power inlet port
⑫	Remote control wiring and inter-unit wiring inlet port
⑬	Wireless remote controller receiver installation location
⑭	Outside air intake duct connection port ( $\phi 100$ mm, cutout)*

\* Necessary to attach duct connecting flange (field supply).

<Filter dimension>  
(421 × 250 × 16) × 2 pcs.

**Hole position of indoor unit rear-side  
(Figure shows view from front)**

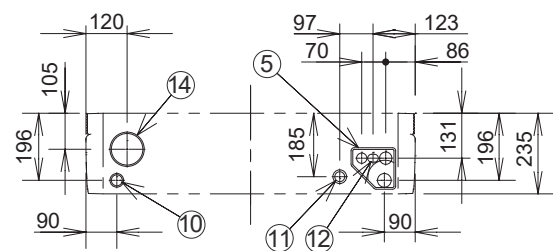

**Tubing hole position on wall surface  
(Figure shows view from front)**

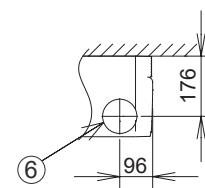

#### 1-2-1-4. Ceiling Type S-6071PT3E

unit :mm

**Detailed view of intaking  
outside air duct connection port**

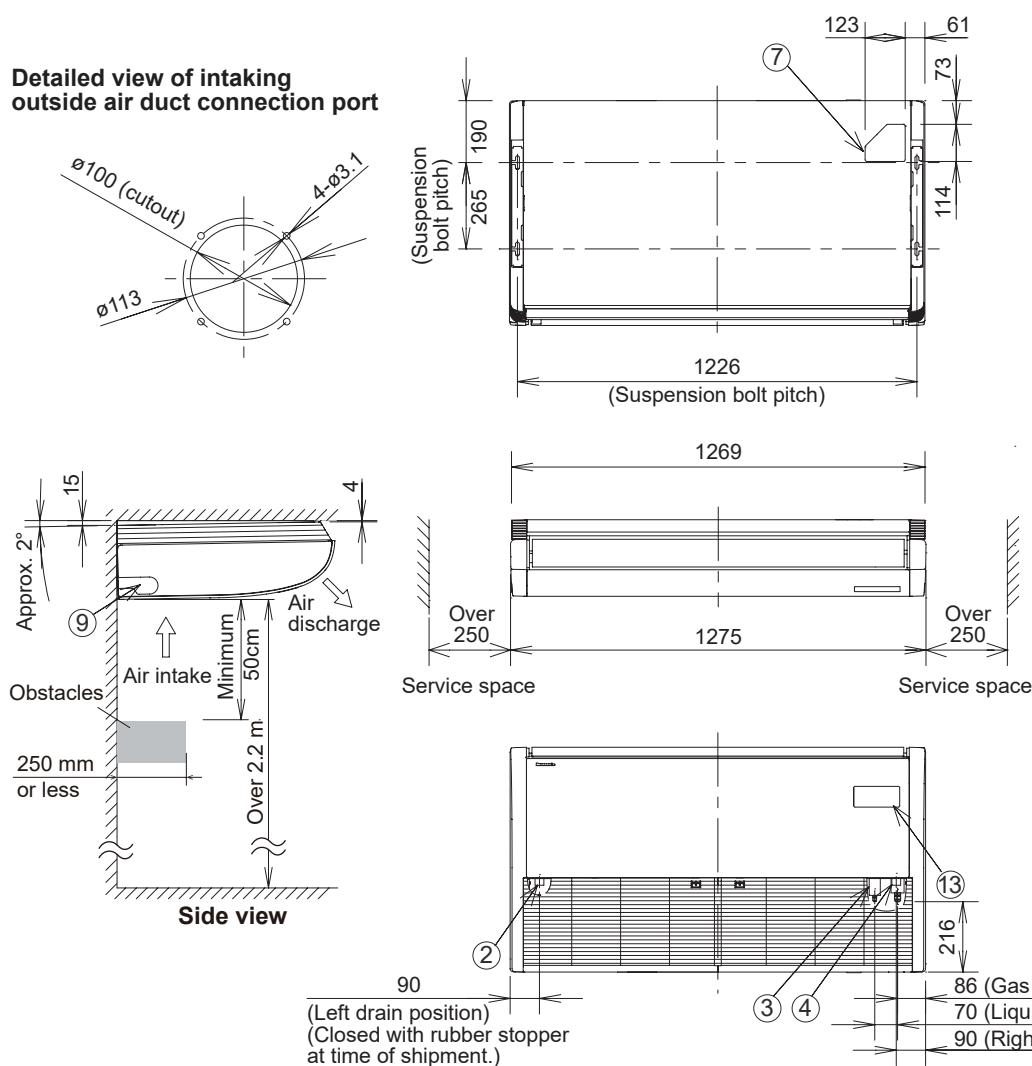

**Distance of each exposed bolt must be of equal length within 50mm.**

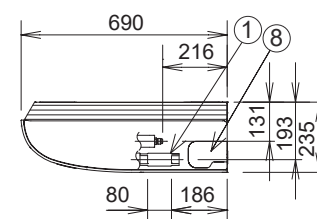
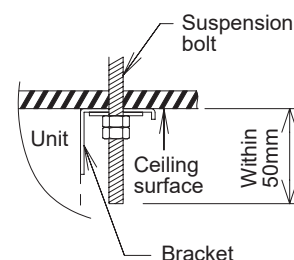

①	Drain port VP20 (inside diameter ø26mm, drain hose supplied)
②	Left drain position
③	Refrigerant liquid tubing (ø9.52mm, flare connection) *1
④	Refrigerant gas tubing (ø15.88mm, flare connection) *2
⑤	Cover of rear tubing hole
⑥	Tubing hole on wall surface (ø100mm)
⑦	Upper side tubing port
⑧	Right side drain hose outlet port (cutout)
⑨	Left side drain hose outlet port (cutout)
⑩	Left-rear side drain hose outlet port (cutout)
⑪	Power inlet port
⑫	Remote control wiring and inter-unit wiring inlet port
⑬	Wireless remote controller receiver installation location
⑭	Outside air intake duct connection port (ø100mm, cutout)*3

\*1 When connecting with U-60PZ3E5A, U-71PZ3E5A or U-60PZH3E5, connect the liquid socket tube (ø9.52-ø6.35) to the liquid tubing side indoor unit.

\*2 When connecting with U-60PZ3E5A or U-60PZH3E5, connect the gas socket tube (ø15.88-ø12.7) to the gas tubing side indoor unit.

\*3 Necessary to attach duct connecting flange (field supply).

**Hole position of indoor unit rear-side  
(Figure shows view from front)**

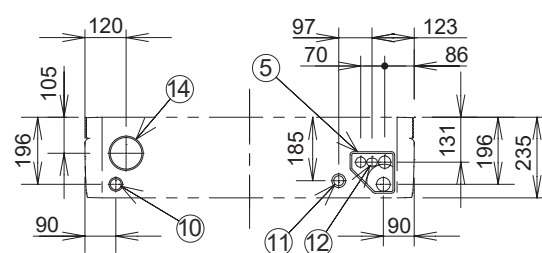

**Tubing hole position on wall surface  
(Figure shows view from front)**

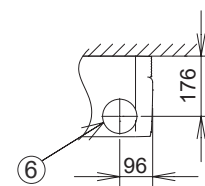

&lt;Filter dimension&gt;

(579 × 250 × 16) × 2 pcs.

unit :mm

### Detailed view of intaking outside air duct connection port

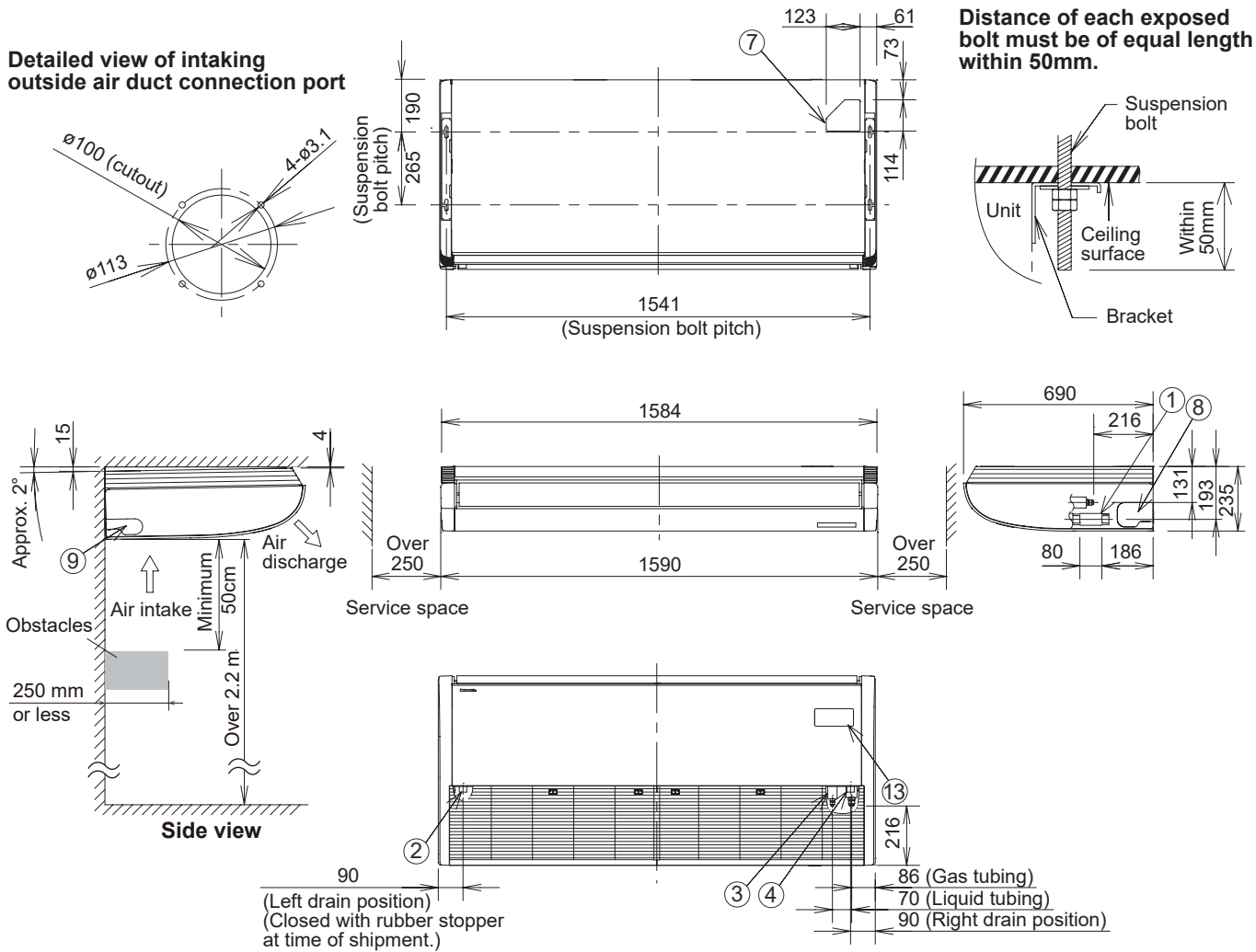

①	Drain port VP20 (inside diameter ø26mm, drain hose supplied)
②	Left drain position
③	Refrigerant liquid tubing (ø9.52mm, flare connection)
④	Refrigerant gas tubing (ø15.88mm, flare connection)
⑤	Cover of rear tubing hole
⑥	Tubing hole on wall surface (ø100mm)
⑦	Upper side tubing port
⑧	Right side drain hose outlet port (cutout)
⑨	Left side drain hose outlet port (cutout)
⑩	Left-rear side drain hose outlet port (cutout)
⑪	Power inlet port
⑫	Remote control wiring and inter-unit wiring inlet port
⑬	Wireless remote controller receiver installation location
⑭	Outside air intake duct connection port (ø100mm, cutout) *

<Filter dimension>  
(736 × 250 × 16 × 2 pcs.)

**Hole position of indoor unit rear-side  
(Figure shows view from front)**

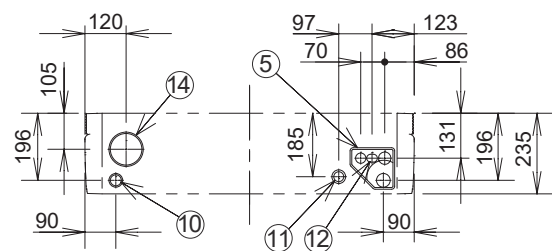

**Tubing hole position on wall surface  
(Figure shows view from front)**

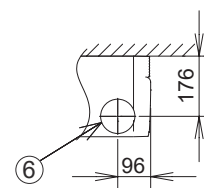

## 1-2-2. Outdoor Unit

### 1-2-2-1. PZ3 U-25PZ3E5, U-36PZ3E5, U-50PZ3E5

Unit: mm

①	Mounting hole (4-R6.5), anchor bolt : M10
②	Refrigerant tubing (liquid tube), flared connection (Ø6.35)
③	Refrigerant tubing (gas tube), flared connection (Ø12.7)

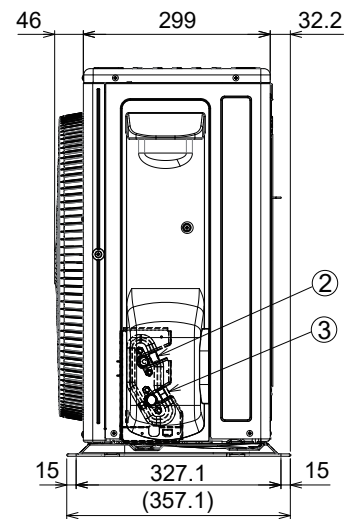
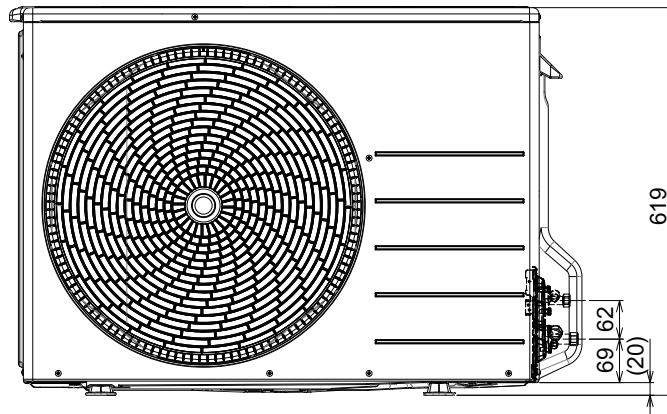
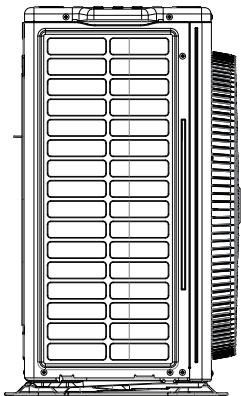
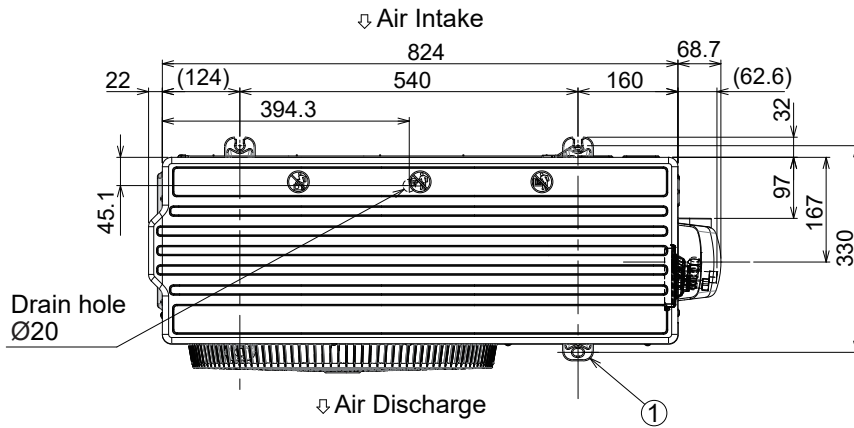

## 1-2-2-1. PZ3 U-60PZ3E5A, U-71PZ3E5A

Unit: mm

①	Mounting hole (4-R6.5), anchor bolt : M10
②	Refrigerant tubing (liquid tube), flared connection (Ø 6.35)
③	Refrigerant tubing (gas tube), flared connection U-60PZ3E5A (Ø12.7) U-71PZ3E5A (Ø15.88)

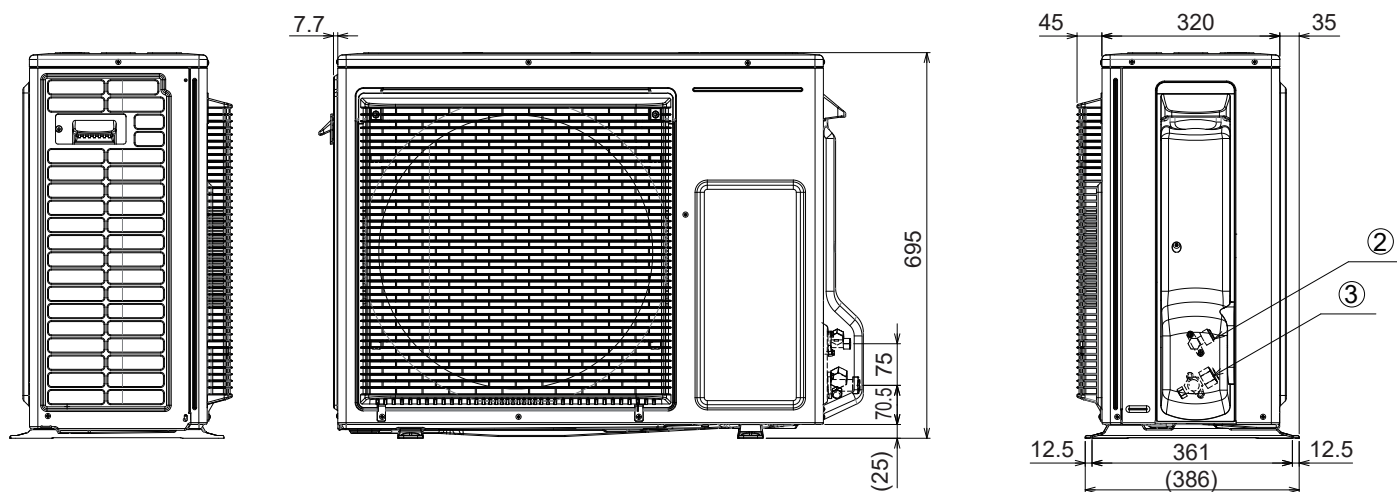
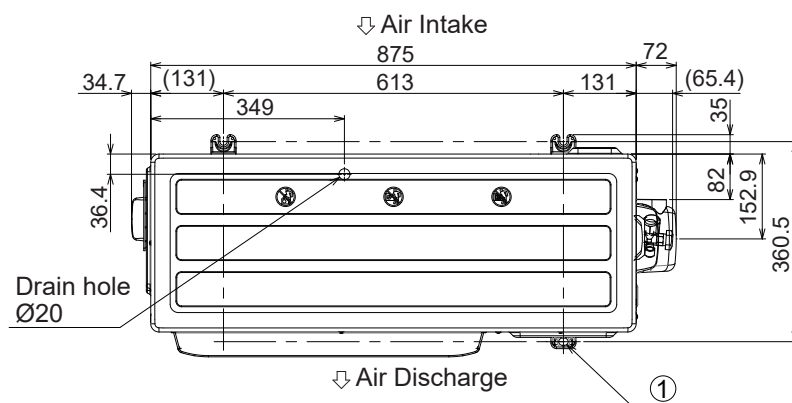

**1-2-2-1. PZ3 U-100PZ3E5, U-125PZ3E5, U-140PZ3E5  
U-100PZ3E8, U-125PZ3E8, U-140PZ3E8**

Unit: mm

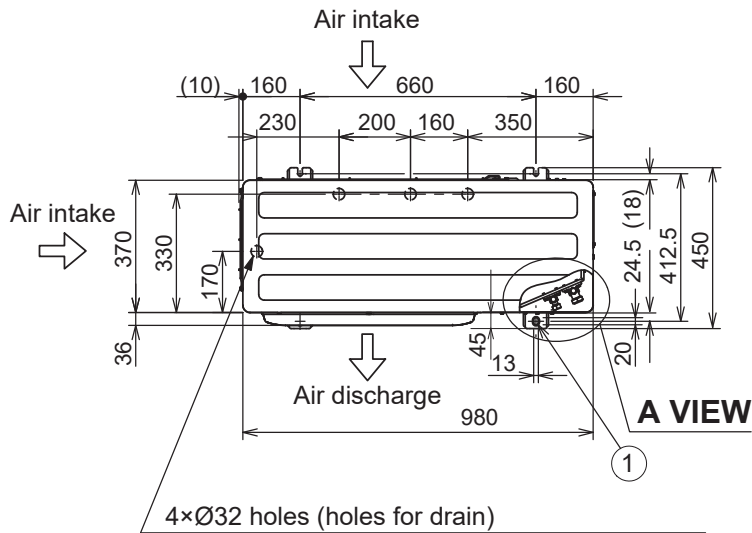

①	Mounting hole (4-R6.5), anchor bolt : M10
②	Refrigerant tubing (liquid tube), flared connection (Ø9.52)
③	Refrigerant tubing (gas tube), flared connection (Ø15.88)
④	Refrigerant tubing port
⑤	Electrical wiring port (Ø13)
⑥	Electrical wiring port (Ø22)
⑦	Electrical wiring port (Ø27)
⑧	Electrical wiring port (Ø35)

When using a drain pipe, install the drain socket (field supply) on to the drain hole. Seal the other drain hole with the rubber cap.

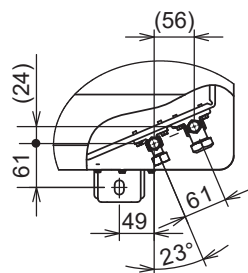
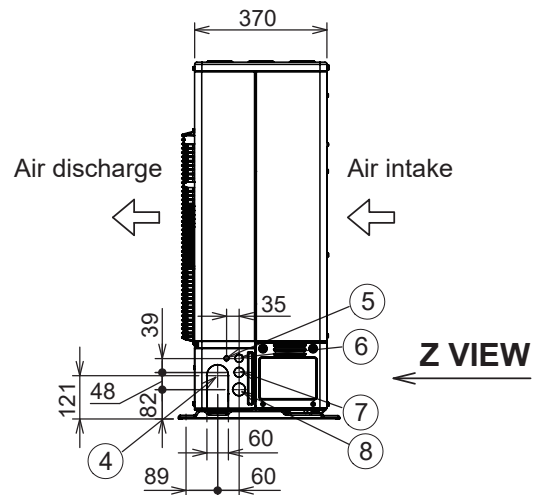
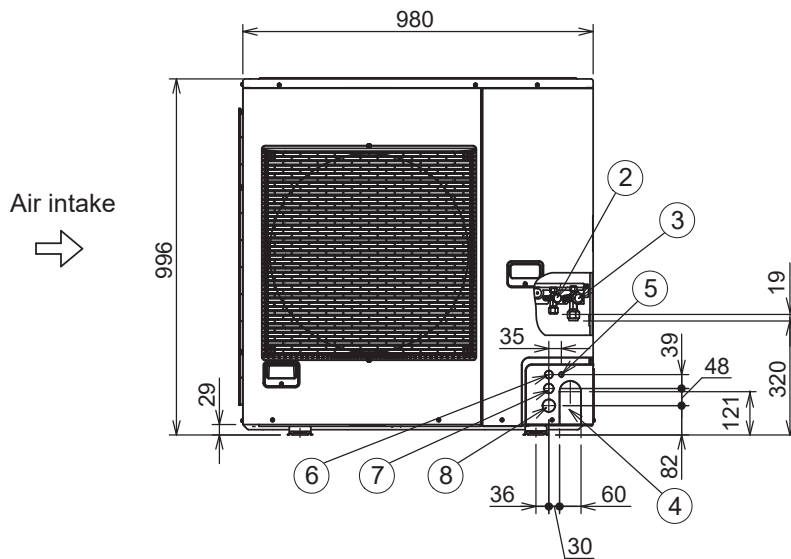

**A VIEW**

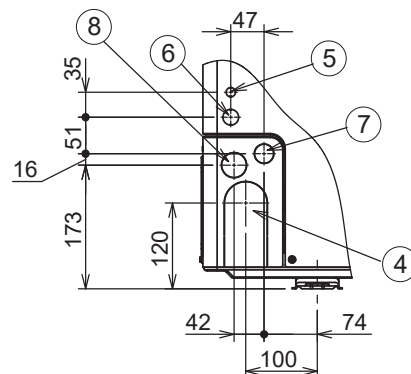

**Z VIEW**